

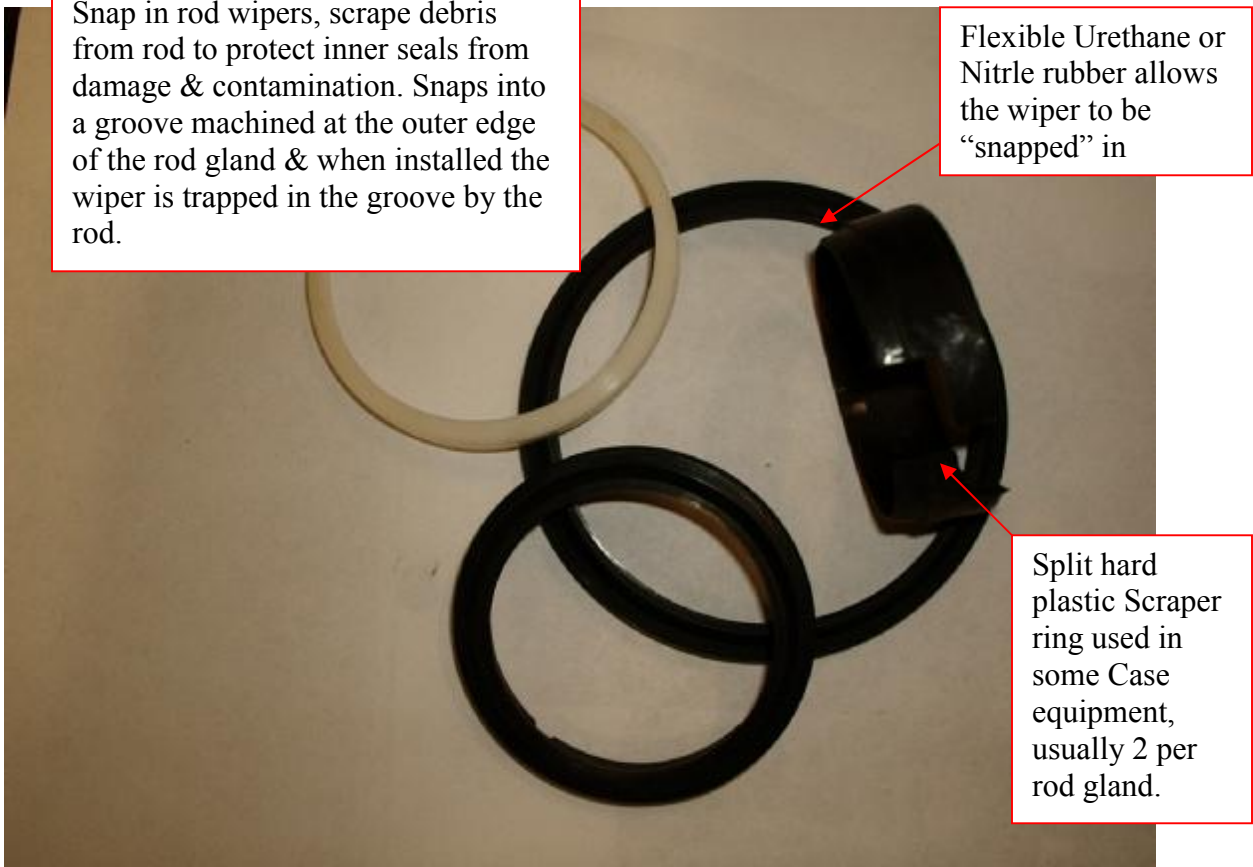

This information is provided to aid in part selection; this does not replace equipment manufacturer's instructions. Always read, understand and follow manufacturer's instructions for disassembly, repair, reassembly & operation. We do not provide instructions with our seal kits, you must obtain service information from the equipment manufacturer. Winking fox logo TM Fox Prints, Fox Machine.



Snap in rod wipers, scrape debris from rod to protect inner seals from damage & contamination. Snaps into a groove machined at the outer edge of the rod gland & when installed the wiper is trapped in the groove by the rod.

Flexible Urethane or Nitrile rubber allows the wiper to be "snapped" in

Split hard plastic Scraper ring used in some Case equipment, usually 2 per rod gland.